

ACTION AREA - I

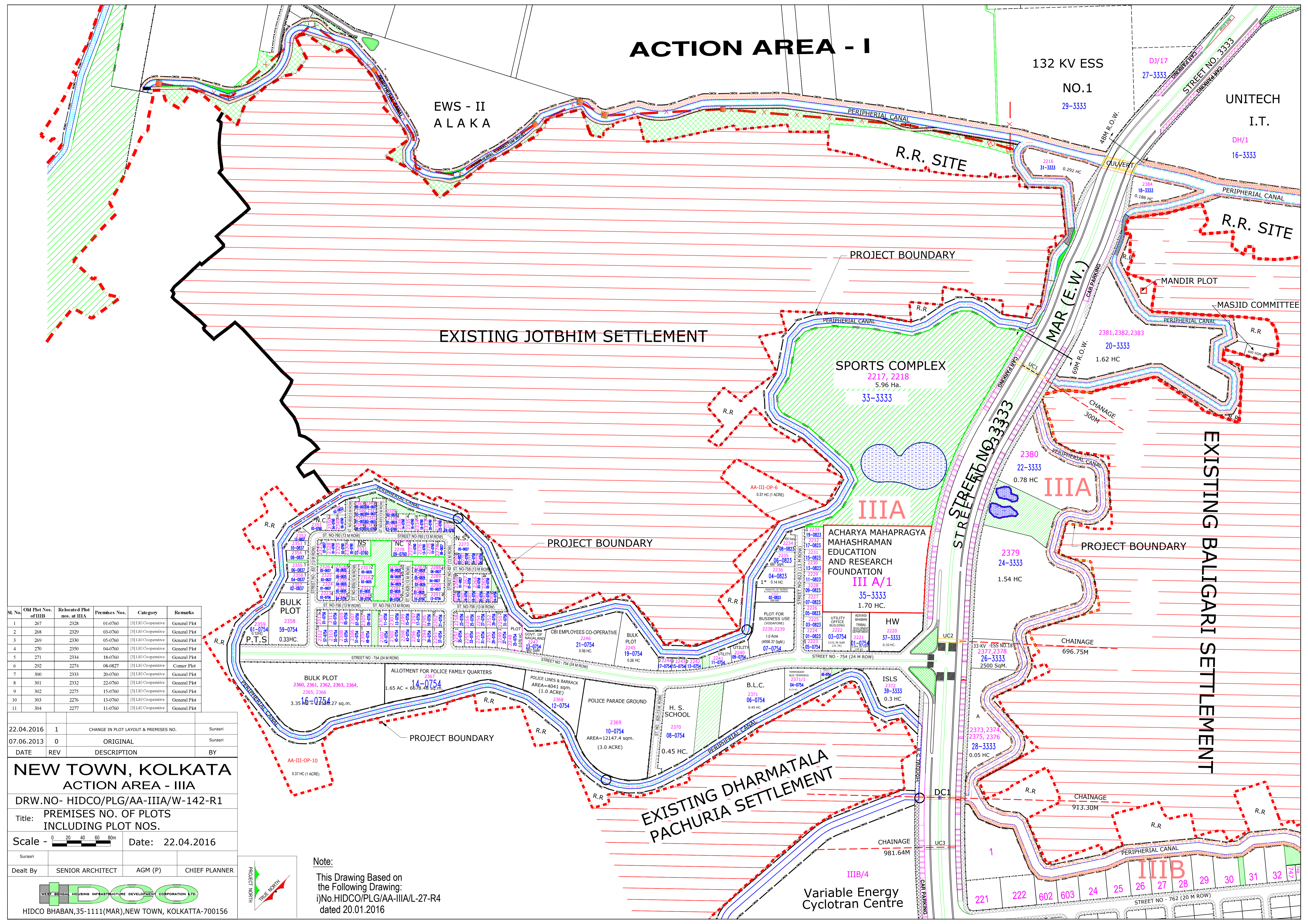

Sl. No.	Old Plot Nos. of IIB	Relocated Plot nos. at IIIA	Premises Nos.	Category	Remarks
1	267	2328	01-0760	[3] LG Cooperative	General Plot
2	268	2329	03-0760	[3] LG Cooperative	General Plot
3	269	2330	05-0760	[3] LG Cooperative	General Plot
4	270	2330	04-0760	[3] LG Cooperative	General Plot
5	271	2334	18-0760	[3] LG Cooperative	General Plot
6	292	2274	08-0827	[3] LG Cooperative	Corner Plot
7	300	2333	20-0760	[3] LG Cooperative	General Plot
8	301	2332	22-0760	[3] LG Cooperative	General Plot
9	302	2275	15-0760	[3] LG Cooperative	General Plot
10	303	2276	13-0760	[3] LG Cooperative	General Plot
11	304	2277	11-0760	[3] LG Cooperative	General Plot

DATE	REV	DESCRIPTION	BY
22.04.2016	1	CHANGE IN PLOT LAYOUT & PREMISES NO.	Surasri
07.06.2013	0	ORIGINAL	Surasri

NEW TOWN, KOLKATA
ACTION AREA - IIIA
 DRW.NO- HIDCO/PLG/AA-III A/W-142-R1
 Title: PREMISES NO. OF PLOTS INCLUDING PLOT NOS.
 Scale - Date: 22.04.2016

Dealt By	SENIOR ARCHITECT	AGM (P)	CHIEF PLANNER
----------	------------------	---------	---------------

HIDCO BHABAN, 35-1111(MAR), NEW TOWN, KOLKATA-700156

Note:
 This Drawing Based on the Following Drawing:
 i) No.HIDCO/PLG/AA-III A/L-27-R4 dated 20.01.2016

